



THE HOLT RENFREW CENTRE

Toronto, Ontario

Holt Renfrew Centre is located steps from Yonge Street on Bloor in Toronto. With over 7 million visits a year, close to the TTC's busiest subway stop, and the unofficial anchor of Canada's Mink Mile, the Holt Renfrew Centre sales surpass \$1,000 per square foot.



CENTRE PROFILE

| | |
|---------------------------|---------|
| Total Square Feet | 274,022 |
| Total SF of CRU Tenants | 72,714 |
| Number of Stores/Services | 38 |
| Number of Levels | 4 |

MARKET DEMOGRAPHICS

| | |
|---------------------------|-----------|
| Primary Trade Area | |
| Population | 584,084 |
| Number of Households | 312,429 |
| Average Household Income | \$120,547 |

Traffic

| | |
|---------------------------|-----------|
| Annual Pedestrian Traffic | 7,211,000 |
|---------------------------|-----------|

Source:
Market Demographics: Environics Analytics,
DemoStats Trends, 2017.

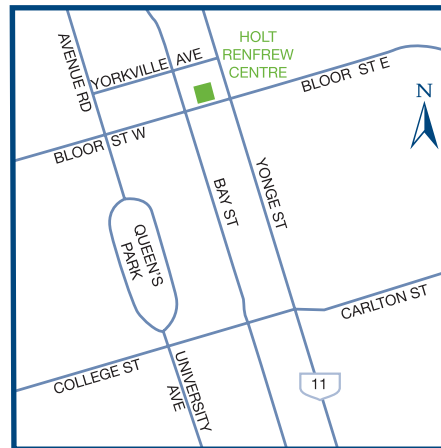

THE HOLT RENFREW CENTRE
50 - 60 Bloor Street West
Toronto, ON M4W 3L8
Phone 416-923-8855
holtrenfrewcentre.ca

LEASING INQUIRIES

Morguard Brokerage
55 City Centre Drive, Suite 800, Mississauga, ON L5B 1M3
Phone 905-281-3800 Toll Free 1-800-928-6255
leasing@morguard.com
morguard.com



Real Estate Potential. Realized.

THE HOLT RENFREW CENTRE

TENANT LIST

WOMEN'S APPAREL

| | |
|-------------------|---------|
| Aritzia * | 006/A07 |
| Femme de Carriere | C11/C12 |
| M for Mendocino | C13 |

UNISEX APPAREL

| | |
|-----|--------|
| Gap | B/C-06 |
|-----|--------|

FASHION ACCESSORIES

| | |
|---------|-----|
| Fossil | A05 |
| Optique | C07 |

SPECIALTY APPAREL

| | |
|----------------|------|
| Legs Beautiful | C24A |
|----------------|------|

ELECTRONICS

| | |
|----------------|-----|
| Bell World | C06 |
| Freedom Mobile | C08 |

HEALTH & BEAUTY

| | |
|-----------------------|------|
| Adore | C09 |
| Caryl Baker Visage | C-12 |
| Crabtree & Evelyn | 009 |
| Concepts | C-14 |
| Escentis Aromatherapy | C03 |
| Gingko | C05 |
| Mocelle Edan Spa | 037 |
| Oro Gold Cosmetics | 035 |
| Trade Secrets | 008 |

GENERAL MERCHANDISE & VARIETY

| | |
|--------------|------|
| Tobacco Road | C-01 |
|--------------|------|

SPECIALTY FOOD

| | |
|-----------------------|---------------|
| Freshly Squeezed | C14 |
| Lindt Chocolates | C15/C16 |
| Real Fruit Bubble Tea | C-04 |
| Second Cup | C-11 |
| Starbucks Coffee | C10 |
| Tim Hortons | 055/C-02/C23A |

RESTAURANTS

| | |
|---------|------|
| Druxy's | C-10 |
| Picnic | C-08 |
| Planta | A |

SERVICES

| | |
|---------------------|------|
| Flight Centre | C24 |
| Josephson Opticians | C |
| Stitch It | C-03 |

MAJOR TENANTS

| | |
|--------------|-----------------|
| Holt Renfrew | Shaded |
| Zara | A04/C25/C26/C27 |

* Opening Spring 2019

THE HOLT RENFREW CENTRE

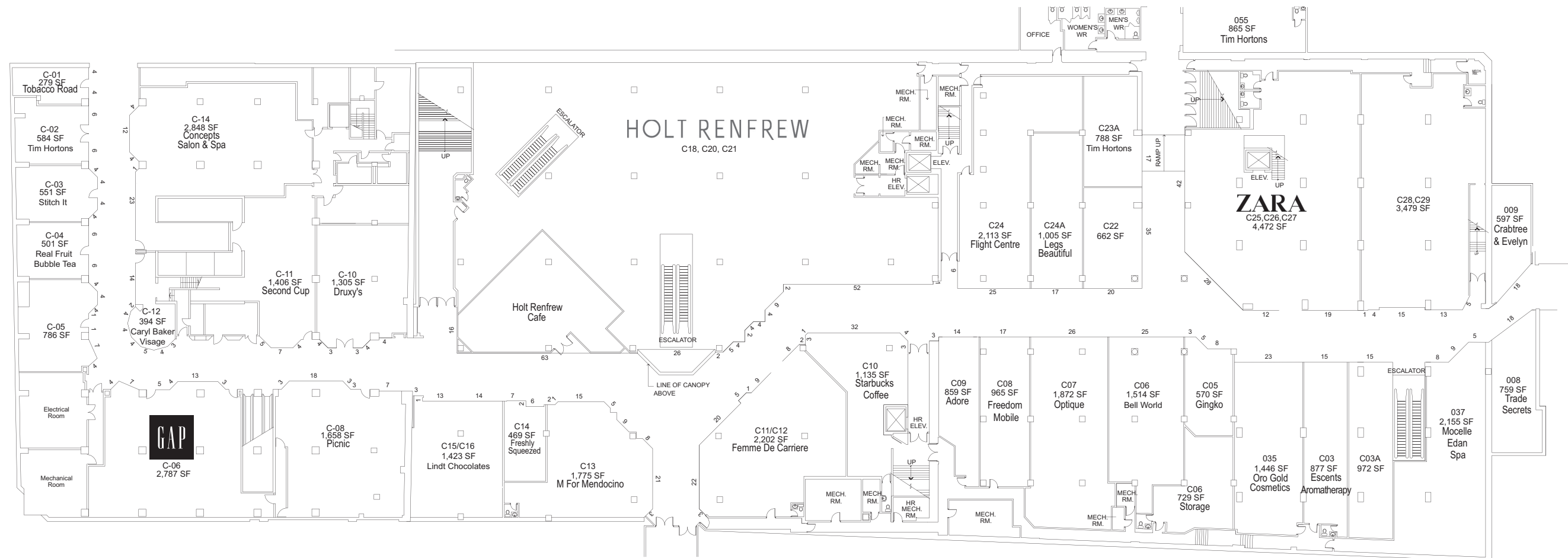

Concourse Level

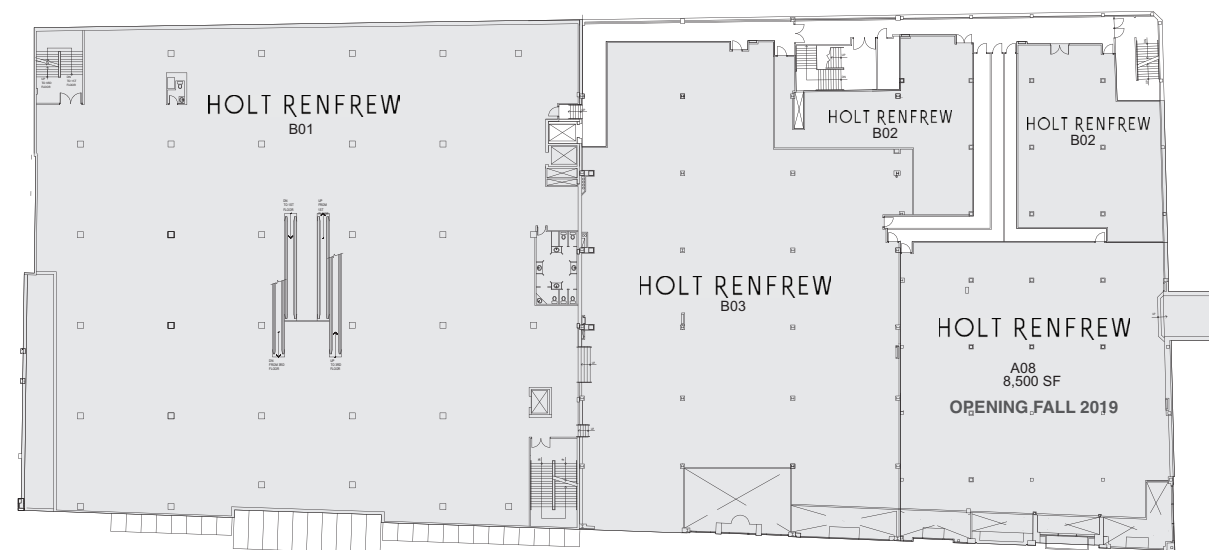

Level Two

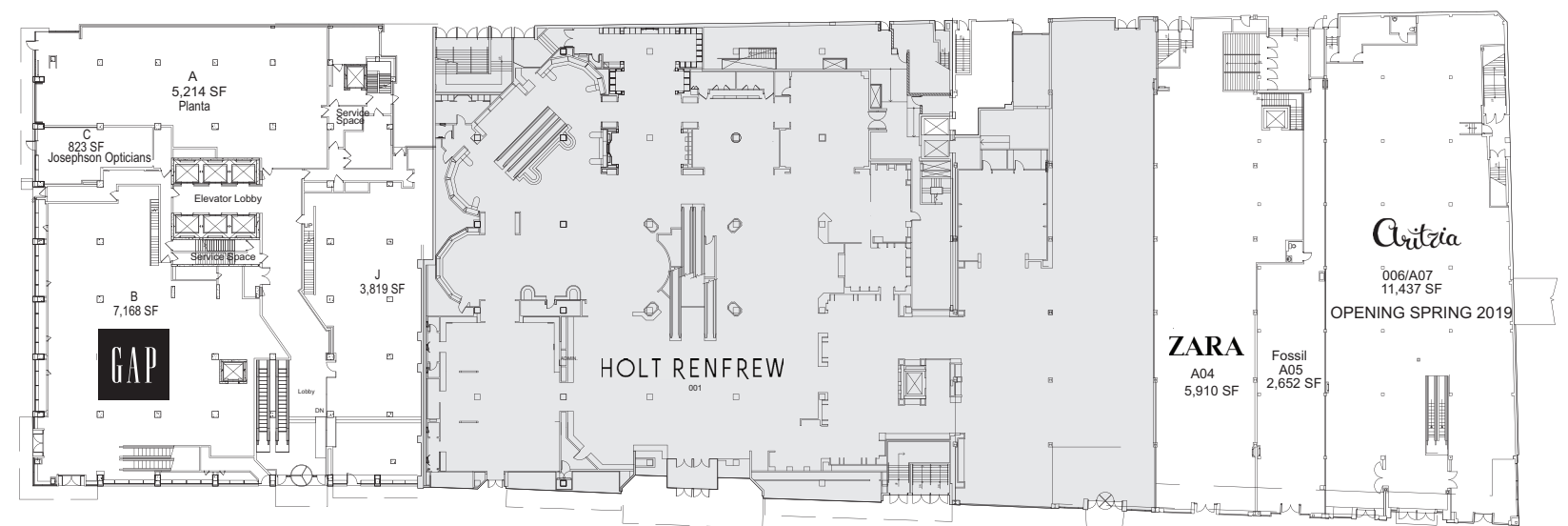

Ground Level